

## SUN ODYSSEY 380

*DIANA (2022)*



---

**BeBlue S.R.L. • Via Barche 53 • 30035 Mirano (Ve) • Italy**

Telephone: [+39 041 86 27 010](tel:+390418627010)

E-mail: [info@beblue.it](mailto:info@beblue.it)

Web: [www.bebluesailing.com](http://www.bebluesailing.com)

---

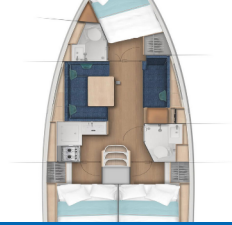

Marina	Cannigione, Italy
Yacht ID	318465
Shipyard	Jeanneau
Boat Name	DIANA
Year	2022
Length	11.22 M
Cabins	3
Beds	6 + 2
WC/Shower	2

**DECK EQUIPMENTS:** Anchor with chain, Auxiliary anchor, Bimini top, Boat hook, Bosun's chair (Safe seat)(boatswain's chair), Cockpit cushions, Cockpit/stern, outside shower, Deck brush, Electric anchor windlass, Fenders, Fuel funnel, Gangway, Mooring ropes , Plastic bucket, Sprayhood, Swimming ladder, Water hose, Winch handles, Battery charger , Bilge pump - electric, Shore power cable, VHF radio , Barometer, Bed linen, Bilge pump - mechanic, Blankets, Clock, Hand-held compass , Pillows, Table, Towels, Coffee machine, Gas bottles, Hot water, Kitchen utensils (Galley equipment, cutlery), Oven, Refrigerator, Stove, Autopilot, Binoculars, Compass, Echosounder/Depthsounder, GPS chart plotter, Log, Pilot book, Radar reflector, Wind instrument/Anemometer, CD player, Fins, Outside speakers, Buoyant smoke signal, Distress flare box, Emergency tiller, Fire extinguisher , First aid kit , Fog horn, Horseshoe lifebuoy, Life belts (Safety harness), Life jackets, Lifteraft , Torch

**ELECTRICAL SYSTEM:** Anchor with chain, Auxiliary anchor, Bimini top, Boat hook, Bosun's chair (Safe seat)(boatswain's chair), Cockpit cushions, Cockpit/stern, outside shower, Deck brush, Electric anchor windlass, Fenders, Fuel funnel, Gangway, Mooring ropes , Plastic bucket, Sprayhood, Swimming ladder, Water hose, Winch handles, Battery charger , Bilge pump - electric, Shore power cable, VHF radio , Barometer, Bed linen, Bilge pump - mechanic, Blankets, Clock, Hand-held compass , Pillows, Table, Towels, Coffee machine, Gas bottles, Hot water, Kitchen utensils (Galley equipment, cutlery), Oven, Refrigerator, Stove, Autopilot, Binoculars, Compass, Echosounder/Depthsounder, GPS chart plotter, Log, Pilot book, Radar reflector, Wind instrument/Anemometer, CD player, Fins, Outside speakers, Buoyant smoke signal, Distress flare box, Emergency tiller, Fire extinguisher , First aid kit , Fog horn, Horseshoe lifebuoy, Life belts (Safety harness), Life jackets, Lifteraft , Torch

**INTERIOR DESIGN:** Anchor with chain, Auxiliary anchor, Bimini top, Boat hook, Bosun's chair (Safe seat)(boatswain's chair), Cockpit cushions, Cockpit/stern, outside shower, Deck brush, Electric anchor windlass, Fenders, Fuel funnel, Gangway, Mooring ropes , Plastic bucket, Sprayhood, Swimming ladder, Water hose, Winch handles, Battery charger , Bilge pump – electric, Shore power cable, VHF radio , Barometer, Bed linen, Bilge pump – mechanic, Blankets, Clock, Hand-held compass , Pillows, Table, Towels, Coffee machine, Gas bottles, Hot water, Kitchen utensils (Galley equipment, cutlery), Oven, Refrigerator, Stove, Autopilot, Binoculars, Compass, Echosounder/Depthsounder, GPS chart plotter, Log, Pilot book, Radar reflector, Wind instrument/Anemometer, CD player, Fins, Outside speakers, Buoyant smoke signal, Distress flare box, Emergency tiller, Fire extinguisher , First aid kit , Fog horn, Horseshoe lifebuoy, Life belts (Safety harness), Life jackets, Liferaft , Torch

**KITCHEN:** Anchor with chain, Auxiliary anchor, Bimini top, Boat hook, Bosun's chair (Safe seat)(boatswain's chair), Cockpit cushions, Cockpit/stern, outside shower, Deck brush, Electric anchor windlass, Fenders, Fuel funnel, Gangway, Mooring ropes , Plastic bucket, Sprayhood, Swimming ladder, Water hose, Winch handles, Battery charger , Bilge pump – electric, Shore power cable, VHF radio , Barometer, Bed linen, Bilge pump – mechanic, Blankets, Clock, Hand-held compass , Pillows, Table, Towels, Coffee machine, Gas bottles, Hot water, Kitchen utensils (Galley equipment, cutlery), Oven, Refrigerator, Stove, Autopilot, Binoculars, Compass, Echosounder/Depthsounder, GPS chart plotter, Log, Pilot book, Radar reflector, Wind instrument/Anemometer, CD player, Fins, Outside speakers, Buoyant smoke signal, Distress flare box, Emergency tiller, Fire extinguisher , First aid kit , Fog horn, Horseshoe lifebuoy, Life belts (Safety harness), Life jackets, Liferaft , Torch

**NAVIGATION SYSTEM:** Anchor with chain, Auxiliary anchor, Bimini top, Boat hook, Bosun's chair (Safe seat)(boatswain's chair), Cockpit cushions, Cockpit/stern, outside shower, Deck brush, Electric anchor windlass, Fenders, Fuel funnel, Gangway, Mooring ropes , Plastic bucket, Sprayhood, Swimming ladder, Water hose, Winch handles, Battery charger , Bilge pump – electric, Shore power cable, VHF radio , Barometer, Bed linen, Bilge pump – mechanic, Blankets, Clock, Hand-held compass , Pillows, Table, Towels, Coffee machine, Gas bottles, Hot water, Kitchen utensils (Galley equipment, cutlery), Oven, Refrigerator, Stove, Autopilot, Binoculars, Compass, Echosounder/Depthsounder, GPS chart plotter, Log, Pilot book, Radar reflector, Wind instrument/Anemometer, CD player, Fins, Outside speakers, Buoyant smoke signal, Distress flare box,

## PRICES AND AVAILABILITY

Sun Odyssey 380 DIANA (2022)



<b>31.05. - 07.06.2025</b> Booked	<b>07.06. - 14.06.2025</b> Booked	<b>14.06. - 21.06.2025</b> Booked	<b>21.06. - 28.06.2025</b> Booked
<b>28.06. - 05.07.2025</b> Booked	<b>05.07. - 12.07.2025</b> Booked	<b>16.08. - 23.08.2025</b> Booked	<b>23.08. - 30.08.2025</b> Booked
<b>30.08. - 06.09.2025</b> Booked	<b>20.09. - 27.09.2025</b> Booked	<b>04.10. - 11.10.2025</b> 2.160 € <del>2.400 €</del>	<b>18.10. - 25.10.2025</b> 2.070 € <del>2.300 €</del>
<b>25.10. - 01.11.2025</b> 2.070 € <del>2.300 €</del>	<b>01.11. - 08.11.2025</b> 2.070 € <del>2.300 €</del>	<b>08.11. - 15.11.2025</b> 2.070 € <del>2.300 €</del>	<b>15.11. - 22.11.2025</b> 2.070 € <del>2.300 €</del>
<b>22.11. - 29.11.2025</b> 2.070 € <del>2.300 €</del>	<b>29.11. - 06.12.2025</b> 2.070 € <del>2.300 €</del>	<b>06.12. - 13.12.2025</b> 2.070 € <del>2.300 €</del>	<b>13.12. - 20.12.2025</b> 2.070 € <del>2.300 €</del>
<b>20.12. - 27.12.2025</b> 2.070 € <del>2.300 €</del>	<b>27.12. - 03.01.2026</b> 2.147 € <del>2.386 €</del>		