

BALI 4.2

LIZZY (2023)



BeBlue S.R.L. • Via Barche 53 • 30035 Mirano (Ve) • Italy

Telefon: +39 041 86 27 010

E-mail: info@beblue.it

Web: www.bebluesailing.com

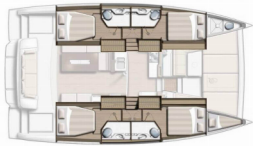

Port Wyjścia	Yachtclub Seget (Marina Baotić), Seget Donji, Chorwacja
Jacht ID	172085
Sztocznia	Catana
Boat Name	LIZZY
Rok	2023
Długość	12.85 M
Kabiny	4 + 1
Łóżka	8 + 1 + 1
Toaleta/ Prysznic	4 + 1

PREMIUM EQUIPMENT: Electric winch, Heating

DECK EQUIPMENTS: Anchor with chain, Bimini top, Black Water Tank, Boat hook, Bosun's chair (Safe seat)(boatswain's chair), Chain counter on helm station, Cockpit cushions, Cockpit table, Cockpit/stern, outside shower, Deck brush, Electric anchor windlass, Fenders, Gangway, Jerry can for fuel (outboard), Mooring ropes , Plastic bucket, Round/globular fender, Spare anchor (Reserve, Auxiliary anchor), Spring cleats, Swimming ladder, Teak cockpit, Water hose, Winch handles, Batteries, Bilge pump - Electric, Inverter, Shore power cable, Start battery, VHF radio , Water heater, WC pump, Bilge pump - mechanic, Blankets, Clothes hangers, Electric fans in cabins, Heating, Pillows, Toilet brush, Bin bag, Freezer, Gas bottles, Gas cookers, Kitchen utensils (Galley equipment, cutlery), Oven, Refrigerator, Autopilot, Binoculars, Compass, GPS chart plotter, LED Navigation lights, Nautical charts, Navigation set, Radar reflector, Tridata, Windex, Fins, Mask and snorkel, Wi-Fi Internet, Distress flare box, Fire extinguisher , First aid kit , Fog horn, Horseshoe lifebuoy, Life belts (Safety harness), Life jacket (children), Life jackets, Liferaft , Rescue sling (Life sling), Signal flags, Torch, Electric winch, Winch

ELECTRICAL SYSTEM: Anchor with chain, Bimini top, Black Water Tank, Boat hook, Bosun's chair (Safe seat)(boatswain's chair), Chain counter on helm station, Cockpit cushions, Cockpit table, Cockpit/stern, outside shower, Deck brush, Electric anchor windlass, Fenders, Gangway, Jerry can for fuel (outboard), Mooring ropes , Plastic bucket, Round/globular fender, Spare anchor (Reserve, Auxiliary anchor), Spring cleats, Swimming ladder, Teak cockpit, Water hose, Winch handles, Batteries, Bilge pump - Electric, Inverter, Shore power cable, Start battery, VHF radio , Water heater, WC pump, Bilge pump - mechanic, Blankets, Clothes hangers, Electric fans in cabins, Heating, Pillows, Toilet brush, Bin bag, Freezer, Gas bottles, Gas cookers, Kitchen utensils (Galley equipment, cutlery), Oven, Refrigerator, Autopilot, Binoculars, Compass, GPS chart plotter, LED Navigation lights, Nautical charts, Navigation set, Radar reflector, Tridata, Windex, Fins, Mask and snorkel, Wi-Fi Internet, Distress flare box, Fire extinguisher , First aid kit , Fog horn, Horseshoe lifebuoy, Life belts (Safety harness), Life jacket (children), Life jackets, Liferaft , Rescue sling (Life sling), Signal flags, Torch, Electric winch, Winch

INTERIOR DESIGN: Anchor with chain, Bimini top, Black Water Tank, Boat hook, Bosun's chair (Safe seat)(boatswain's chair), Chain counter on helm station, Cockpit cushions, Cockpit table, Cockpit/stern, outside shower, Deck brush, Electric anchor windlass, Fenders, Gangway, Jerry can for fuel (outboard), Mooring ropes , Plastic bucket, Round/globular fender, Spare anchor (Reserve, Auxiliary anchor), Spring cleats, Swimming ladder, Teak cockpit, Water hose, Winch handles, Batteries, Bilge pump - Electric, Inverter, Shore power cable, Start battery, VHF radio , Water heater, WC pump, Bilge pump - mechanic, Blankets, Clothes hangers, Electric fans in cabins, Heating, Pillows, Toilet brush, Bin bag, Freezer, Gas bottles, Gas cookers, Kitchen utensils (Galley equipment, cutlery), Oven, Refrigerator, Autopilot, Binoculars, Compass, GPS chart plotter, LED Navigation lights, Nautical charts, Navigation set, Radar reflector, Tridata, Windex, Fins, Mask and snorkel, Wi-Fi Internet, Distress flare box, Fire extinguisher , First aid kit , Fog horn, Horseshoe lifebuoy, Life belts (Safety harness), Life jacket (children), Life jackets, Liferaft , Rescue sling (Life sling), Signal flags, Torch, Electric winch, Winch

KITCHEN: Anchor with chain, Bimini top, Black Water Tank, Boat hook, Bosun's chair (Safe seat)(boatswain's chair), Chain counter on helm station, Cockpit cushions, Cockpit table, Cockpit/stern, outside shower, Deck brush, Electric anchor windlass, Fenders, Gangway, Jerry can for fuel (outboard), Mooring ropes , Plastic bucket, Round/globular fender, Spare anchor (Reserve, Auxiliary anchor), Spring cleats, Swimming ladder, Teak cockpit, Water hose, Winch handles, Batteries, Bilge pump - Electric, Inverter, Shore power cable, Start battery, VHF radio , Water heater, WC pump, Bilge pump - mechanic, Blankets, Clothes hangers, Electric fans in cabins, Heating, Pillows, Toilet brush, Bin bag, Freezer, Gas bottles, Gas cookers, Kitchen utensils (Galley equipment, cutlery), Oven, Refrigerator, Autopilot, Binoculars, Compass, GPS chart plotter, LED Navigation lights, Nautical charts, Navigation set, Radar reflector, Tridata, Windex, Fins, Mask and snorkel, Wi-Fi Internet, Distress flare box, Fire extinguisher , First aid kit , Fog horn, Horseshoe lifebuoy, Life belts (Safety harness), Life jacket (children), Life jackets, Liferaft , Rescue sling (Life sling), Signal flags, Torch, Electric winch, Winch

NAVIGATION SYSTEM: Anchor with chain, Bimini top, Black Water Tank, Boat hook, Bosun's chair (Safe seat)(boatswain's chair), Chain counter on helm station, Cockpit cushions, Cockpit table, Cockpit/stern, outside shower, Deck brush, Electric anchor windlass, Fenders, Gangway, Jerry can for fuel (outboard), Mooring ropes , Plastic bucket, Round/globular fender, Spare anchor (Reserve, Auxiliary anchor), Spring cleats,

PRICES AND AVAILABILITY

Bali 4.2 LIZZY (2023)



24.05. - 31.05.2025 zarezerwowany	31.05. - 07.06.2025 zarezerwowany	07.06. - 14.06.2025 zarezerwowany	14.06. - 21.06.2025 zarezerwowany
28.06. - 05.07.2025 zarezerwowany	05.07. - 12.07.2025 zarezerwowany	12.07. - 19.07.2025 zarezerwowany	19.07. - 26.07.2025 11.045 €
26.07. - 02.08.2025 zarezerwowany	02.08. - 09.08.2025 8.479 € 9.975 €	09.08. - 16.08.2025 9.359 € 11.010 €	16.08. - 23.08.2025 zarezerwowany
23.08. - 30.08.2025 zarezerwowany	30.08. - 06.09.2025 6.180 €	13.09. - 20.09.2025 5.096 € 6.370 €	20.09. - 27.09.2025 zarezerwowany
27.09. - 04.10.2025 zarezerwowany	04.10. - 11.10.2025 zarezerwowany	11.10. - 18.10.2025 1.645 € 2.350 €	18.10. - 25.10.2025 1.470 €
25.10. - 01.11.2025 1.470 €	02.11. - 13.03.2026 zarezerwowany		