

# LEOPARD 45

*DARIA (2023)*



---

**BeBlue S.R.L. • Via Barche 53 • 30035 Mirano (Ve) • Italy**

Telefon: +39 041 86 27 010

E-mail: [info@beblue.it](mailto:info@beblue.it)

Web: [www.bebluesailing.com](http://www.bebluesailing.com)

---

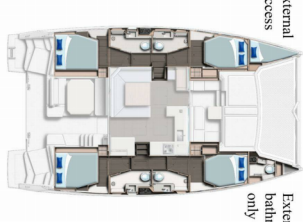

Port Wyjścia	Procida, Włochy
Jacht ID	318449
Sztocznia	Leopard
Boat Name	DARIA
Rok	2023
Długość	13.72 M
Kabiny	4 + 1
Łóżka	8 + 2 + 1
Toaleta/ Prysznic	4 + 1

**PREMIUM EQUIPMENT:** Air condition, Electric winch, Generator, Watermaker – desalinator

**DECK EQUIPMENTS:** Anchor with chain, Boat hook, Bosun's chair (Safe seat)(boatswain's chair), Deck brush, Electric anchor windlass, Fenders, Fuel funnel, Gangway, Hard Top Bimini, Mooring ropes , Plastic bucket, Spare anchor (Reserve, Auxiliary anchor), Swimming ladder, Water hose, Winch handles, Air condition, Bilge pump – Electric, Generator, Inverter, Solar panels, VHF radio , Watermaker – desalinator, Barometer, Bilge pump – mechanic, Clock, Hand-held compass , Pillows, Water Purifier, Coffee machine, Gas bottles, Hot water, Kitchen utensils (Galley equipment, cutlery), Oven, Refrigerator, Stove, Autopilot, Binoculars, Echosounder/Depthsounder, GPS chart plotter, Log, Nautical charts, Pilot book, Radar reflector, Wind instrument/Anemometer, CD player, Fins, Outside speakers, Buoyant smoke signal, Distress flare box, Emergency tiller, Fire extinguisher , First aid kit , Fog horn, Horseshoe lifebuoy, Life belts (Safety harness), Life jackets, Liferaft , Torch, Electric winch

**ELECTRICAL SYSTEM:** Anchor with chain, Boat hook, Bosun's chair (Safe seat)(boatswain's chair), Deck brush, Electric anchor windlass, Fenders, Fuel funnel, Gangway, Hard Top Bimini, Mooring ropes , Plastic bucket, Spare anchor (Reserve, Auxiliary anchor), Swimming ladder, Water hose, Winch handles, Air condition, Bilge pump – Electric, Generator, Inverter, Solar panels, VHF radio , Watermaker – desalinator, Barometer, Bilge pump – mechanic, Clock, Hand-held compass , Pillows, Water Purifier, Coffee machine, Gas bottles, Hot water, Kitchen utensils (Galley equipment, cutlery), Oven, Refrigerator, Stove, Autopilot, Binoculars, Echosounder/Depthsounder, GPS chart plotter, Log, Nautical charts, Pilot book, Radar reflector, Wind instrument/Anemometer, CD player, Fins, Outside speakers, Buoyant smoke signal, Distress flare box, Emergency tiller, Fire extinguisher , First aid kit , Fog horn, Horseshoe lifebuoy, Life belts (Safety harness), Life jackets, Liferaft , Torch, Electric winch

**INTERIOR DESIGN:** Anchor with chain, Boat hook, Bosun's chair (Safe seat)(boatswain's chair), Deck brush, Electric anchor windlass, Fenders, Fuel funnel, Gangway, Hard Top Bimini, Mooring ropes , Plastic bucket, Spare anchor (Reserve, Auxiliary anchor), Swimming ladder, Water hose, Winch handles, Air condition, Bilge pump - Electric, Generator, Inverter, Solar panels, VHF radio , Watermaker - desalinator, Barometer, Bilge pump - mechanic, Clock, Hand-held compass , Pillows, Water Purifier, Coffee machine, Gas bottles, Hot water, Kitchen utensils (Galley equipment, cutlery), Oven, Refrigerator, Stove, Autopilot, Binoculars, Echosounder/Depthsounder, GPS chart plotter, Log, Nautical charts, Pilot book, Radar reflector, Wind instrument/Anemometer, CD player, Fins, Outside speakers, Buoyant smoke signal, Distress flare box, Emergency tiller, Fire extinguisher , First aid kit , Fog horn, Horseshoe lifebuoy, Life belts (Safety harness), Life jackets, Liferaft , Torch, Electric winch

**KITCHEN:** Anchor with chain, Boat hook, Bosun's chair (Safe seat)(boatswain's chair), Deck brush, Electric anchor windlass, Fenders, Fuel funnel, Gangway, Hard Top Bimini, Mooring ropes , Plastic bucket, Spare anchor (Reserve, Auxiliary anchor), Swimming ladder, Water hose, Winch handles, Air condition, Bilge pump - Electric, Generator, Inverter, Solar panels, VHF radio , Watermaker - desalinator, Barometer, Bilge pump - mechanic, Clock, Hand-held compass , Pillows, Water Purifier, Coffee machine, Gas bottles, Hot water, Kitchen utensils (Galley equipment, cutlery), Oven, Refrigerator, Stove, Autopilot, Binoculars, Echosounder/Depthsounder, GPS chart plotter, Log, Nautical charts, Pilot book, Radar reflector, Wind instrument/Anemometer, CD player, Fins, Outside speakers, Buoyant smoke signal, Distress flare box, Emergency tiller, Fire extinguisher , First aid kit , Fog horn, Horseshoe lifebuoy, Life belts (Safety harness), Life jackets, Liferaft , Torch, Electric winch

**NAVIGATION SYSTEM:** Anchor with chain, Boat hook, Bosun's chair (Safe seat)(boatswain's chair), Deck brush, Electric anchor windlass, Fenders, Fuel funnel, Gangway, Hard Top Bimini, Mooring ropes , Plastic bucket, Spare anchor (Reserve, Auxiliary anchor), Swimming ladder, Water hose, Winch handles, Air condition, Bilge pump - Electric, Generator, Inverter, Solar panels, VHF radio , Watermaker - desalinator, Barometer, Bilge pump - mechanic, Clock, Hand-held compass , Pillows, Water Purifier, Coffee machine, Gas bottles, Hot water, Kitchen utensils (Galley equipment, cutlery), Oven, Refrigerator, Stove, Autopilot, Binoculars, Echosounder/Depthsounder, GPS chart plotter, Log, Nautical charts, Pilot book, Radar reflector, Wind instrument/Anemometer, CD player, Fins, Outside

## PRICES AND AVAILABILITY

Leopard 45 DARIA (2023)



<b>24.05. - 31.05.2025</b> 7.160 € 8.950 €	<b>31.05. - 07.06.2025</b> 7.840 € 9.800 €	<b>07.06. - 14.06.2025</b> zarezerwowany	<b>14.06. - 21.06.2025</b> 8.480 € 10.600 €
<b>21.06. - 28.06.2025</b> zarezerwowany	<b>28.06. - 05.07.2025</b> zarezerwowany	<b>05.07. - 12.07.2025</b> zarezerwowany	<b>12.07. - 19.07.2025</b> 9.200 € 11.500 €
<b>19.07. - 26.07.2025</b> zarezerwowany	<b>26.07. - 02.08.2025</b> Under option	<b>02.08. - 09.08.2025</b> zarezerwowany	<b>09.08. - 16.08.2025</b> zarezerwowany
<b>16.08. - 23.08.2025</b> 10.160 € 12.700 €	<b>23.08. - 30.08.2025</b> zarezerwowany	<b>30.08. - 06.09.2025</b> 9.840 € 12.300 €	<b>06.09. - 13.09.2025</b> zarezerwowany
<b>20.09. - 27.09.2025</b> 6.400 € 8.000 €	<b>27.09. - 04.10.2025</b> zarezerwowany	<b>04.10. - 11.10.2025</b> 6.400 € 8.000 €	<b>11.10. - 18.10.2025</b> 3.840 € 4.800 €
<b>18.10. - 25.10.2025</b> 3.840 € 4.800 €	<b>25.10. - 01.11.2025</b> 3.840 € 4.800 €	<b>01.11. - 08.11.2025</b> 4.800 €	<b>08.11. - 15.11.2025</b> 4.800 €
<b>15.11. - 22.11.2025</b> 4.800 €	<b>22.11. - 29.11.2025</b> 4.800 €	<b>29.11. - 06.12.2025</b> 4.800 €	<b>06.12. - 13.12.2025</b> 4.800 €
<b>13.12. - 20.12.2025</b> 4.800 €	<b>20.12. - 27.12.2025</b> 4.800 €	<b>27.12. - 03.01.2026</b> 5.857 €	