

EXCESS 11

Adoc (2022)



BeBlue S.R.L. • Via Barche 53 • 30035 Mirano (Ve) • Italy

Telefon: +39 041 86 27 010

E-mail: info@beblue.it

Web: www.bebluesailing.com

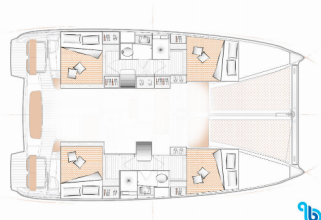

Port Wyjścia	Bandol, Francja
Jacht ID	327847
Sztocznia	Excess
Boat Name	Adoc
Rok	2022
Długość	11.42 M
Kabiny	4
Łóżka	8
Toaleta/ Pysznic	2

PREMIUM EQUIPMENT: Electric toilet, Electric winch

DECK EQUIPMENTS: Bimini Top - Mini, Black Water Tank, Cockpit cushions, Fenders, Mooring ropes , Przednie poduszki kokpitu, Sun tent, 220 volt socket, Battery charger , Converter 12/230V, Service batteries, Shore power connection, Solar panels, VHF radio , Carpet, Electric fans in cabins, Electric toilet, Hand-held compass , Teak interior, Refrigerator, AIS, Autopilot, Compass, Echosounder/Depthsonder, GPS chart plotter, Speedometer (Speed log), Indoor speakers, Outside speakers, Electric winch, Lazy bag

ELECTRICAL SYSTEM: Bimini Top - Mini, Black Water Tank, Cockpit cushions, Fenders, Mooring ropes , Przednie poduszki kokpitu, Sun tent, 220 volt socket, Battery charger , Converter 12/230V, Service batteries, Shore power connection, Solar panels, VHF radio , Carpet, Electric fans in cabins, Electric toilet, Hand-held compass , Teak interior, Refrigerator, AIS, Autopilot, Compass, Echosounder/Depthsonder, GPS chart plotter, Speedometer (Speed log), Indoor speakers, Outside speakers, Electric winch, Lazy bag

INTERIOR DESIGN: Bimini Top - Mini, Black Water Tank, Cockpit cushions, Fenders, Mooring ropes , Przednie poduszki kokpitu, Sun tent, 220 volt socket, Battery charger , Converter 12/230V, Service batteries, Shore power connection, Solar panels, VHF radio , Carpet, Electric fans in cabins, Electric toilet, Hand-held compass , Teak interior, Refrigerator, AIS, Autopilot, Compass, Echosounder/Depthsonder, GPS chart plotter, Speedometer (Speed log), Indoor speakers, Outside speakers, Electric winch, Lazy bag

KITCHEN: Bimini Top - Mini, Black Water Tank, Cockpit cushions, Fenders, Mooring ropes , Przednie poduszki kokpitu, Sun tent, 220 volt socket, Battery charger , Converter 12/230V, Service batteries, Shore power connection, Solar panels, VHF radio , Carpet, Electric fans in cabins, Electric toilet, Hand-held compass , Teak interior, Refrigerator, AIS, Autopilot, Compass, Echosounder/Depthsonder, GPS chart plotter, Speedometer (Speed log), Indoor speakers, Outside speakers, Electric winch, Lazy bag

NAVIGATION SYSTEM: Bimini Top - Mini, Black Water Tank,

Cockpit cushions, Fenders, Mooring ropes , Przednie poduszki kokpitu, Sun tent, 220 volt socket, Battery charger , Converter 12/230V, Service batteries, Shore power connection, Solar panels, VHF radio , Carpet, Electric fans in cabins, Electric toilet, Hand-held compass , Teak interior, Refrigerator, AIS, Autopilot, Compass, Echosounder/Depthsounder, GPS chart plotter, Speedometer (Speed log), Indoor speakers, Outside speakers, Electric winch, Lazy bag

PLEASURE EQUIPMENTS: Bimini Top - Mini, Black Water Tank,

Cockpit cushions, Fenders, Mooring ropes , Przednie poduszki kokpitu, Sun tent, 220 volt socket, Battery charger , Converter 12/230V, Service batteries, Shore power connection, Solar panels, VHF radio , Carpet, Electric fans in cabins, Electric toilet, Hand-held compass , Teak interior, Refrigerator, AIS, Autopilot, Compass, Echosounder/Depthsounder, GPS chart plotter, Speedometer (Speed log), Indoor speakers, Outside speakers, Electric winch, Lazy bag

SAILING EQUIPMENTS: Bimini Top - Mini, Black Water Tank,

Cockpit cushions, Fenders, Mooring ropes , Przednie poduszki kokpitu, Sun tent, 220 volt socket, Battery charger , Converter 12/230V, Service batteries, Shore power connection, Solar panels, VHF radio , Carpet, Electric fans in cabins, Electric toilet, Hand-held compass , Teak interior, Refrigerator, AIS, Autopilot, Compass, Echosounder/Depthsounder, GPS chart plotter, Speedometer (Speed log), Indoor speakers, Outside speakers, Electric winch, Lazy bag

OTHER EQUIPMENT: 3 blade folding propeller, Dinghy, FUSION

sound system, USB socket

PRICES AND AVAILABILITY

Excess 11 Adoc (2022)



23.05. - 25.05.2025 zarezerwowany	28.05. - 01.06.2025 zarezerwowany	06.06. - 09.06.2025 zarezerwowany	14.06. - 21.06.2025 4.700 €
21.06. - 28.06.2025 5.280 €	28.06. - 05.07.2025 5.280 €	05.07. - 12.07.2025 4.560 € 5.700 €	12.07. - 19.07.2025 4.560 € 5.700 €
19.07. - 26.07.2025 4.840 € 6.050 €	26.07. - 09.08.2025 zarezerwowany	16.08. - 23.08.2025 zarezerwowany	23.08. - 30.08.2025 6.270 €
30.08. - 06.09.2025 5.700 €	06.09. - 13.09.2025 5.700 €	13.09. - 20.09.2025 5.280 €	20.09. - 27.09.2025 5.280 €
27.09. - 04.10.2025 4.700 €	04.10. - 11.10.2025 4.700 €	11.10. - 18.10.2025 4.700 €	18.10. - 25.10.2025 4.700 €
25.10. - 01.11.2025 4.700 €			