

## LAGOON 50

*CU SAILING (2020)*



---

**BeBlue S.R.L. • Via Barche 53 • 30035 Mirano (Ve) • Italy**

Telefon: +39 041 86 27 010

E-mail: [info@beblue.it](mailto:info@beblue.it)

Web: [www.bebluesailing.com](http://www.bebluesailing.com)

---

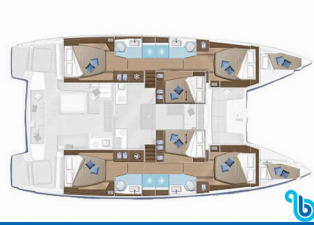

Port Wyjścia	BVI, Tortola, Nanny Cay Marina, Brytyjskie Wyspy Dziewicze
Jacht ID	34154
Sztocznia	Lagoon-Bénéteau
Boat Name	CU SAILING
Rok	2020
Długość	14.75 M
Kabiny	6 + 2
Łóżka	12 + 2
Toaleta/ Prysznic	4

**PREMIUM EQUIPMENT:** Air condition, Electric toilet, Electric winch, Generator

**DECK EQUIPMENTS:** Anchor with chain, Bimini top, Black Water Tank, Boat hook, Bosun's chair (Safe seat)(boatswain's chair), Cockpit cushions, Cockpit table, Cockpit/stern, outside shower, Deck brush, Deck lights, Electric anchor windlass, Fenders, Gangway, Grill (Barbecue) , Jerry can for fuel (outboard), Mooring Cleats, Mooring ropes , Round/globular fender, Spare anchor (Reserve, Auxiliary anchor), Spring cleats, Swimming ladder, Teak cockpit, Water hose, Winch handles, 110V socket, Air condition, Bilge pump - Electric, DSC station, Generator, Motor hours counter, Service batteries, Shore power cable, Start battery, VHF radio , Water heater, WC pump, Bilge pump - mechanic, Blankets, Clothes hangers, Electric fans in cabins, Electric toilet, Pillows, Toilet brush, Blender, Electrical filter coffee machine, Gas bottles, Gas cookers, Kitchen utensils (Galley equipment, cutlery), Microwave, Oven, Refrigerator, Toaster, Autopilot, Binoculars, Compass, GPS chart plotter, Nautical charts, Navigation set, Radar reflector, Tridata, Windex, Fins, Mask and snorkel, Radio CD mp3 player + USB, Stand up paddle (SUP)- FREE, Distress flare box, Emergency tiller, Fire extinguisher , First aid kit , Fog horn, Horseshoe lifebuoy, Life belts (Safety harness), Life jacket (children), Life jackets, Liferaft , Rescue sling (Life sling), Signal flags, Torch, Electric winch, Lazy bag, Winch

**ELECTRICAL SYSTEM:** Anchor with chain, Bimini top, Black Water Tank, Boat hook, Bosun's chair (Safe seat)(boatswain's chair), Cockpit cushions, Cockpit table, Cockpit/stern, outside shower, Deck brush, Deck lights, Electric anchor windlass, Fenders, Gangway, Grill (Barbecue) , Jerry can for fuel (outboard), Mooring Cleats, Mooring ropes , Round/globular fender, Spare anchor (Reserve, Auxiliary anchor), Spring cleats, Swimming ladder, Teak cockpit, Water hose, Winch handles, 110V socket, Air condition, Bilge pump - Electric, DSC station, Generator, Motor hours counter, Service batteries, Shore power cable, Start battery, VHF radio , Water heater, WC pump, Bilge pump - mechanic, Blankets, Clothes hangers, Electric fans in cabins, Electric toilet, Pillows, Toilet brush, Blender, Electrical filter coffee machine, Gas bottles, Gas cookers, Kitchen utensils (Galley equipment, cutlery), Microwave, Oven, Refrigerator, Toaster, Autopilot, Binoculars, Compass, GPS chart plotter, Nautical charts, Navigation set, Radar reflector, Tridata, Windex, Fins, Mask and snorkel, Radio CD mp3 player + USB, Stand up paddle (SUP)- FREE, Distress flare box, Emergency tiller, Fire extinguisher , First aid kit , Fog horn, Horseshoe lifebuoy, Life belts (Safety harness), Life jacket (children), Life jackets, Liferaft , Rescue sling (Life sling), Signal flags, Torch, Electric winch, Lazy bag, Winch

**INTERIOR DESIGN:** Anchor with chain, Bimini top, Black Water Tank, Boat hook, Bosun's chair (Safe seat)(boatswain's chair), Cockpit cushions, Cockpit table, Cockpit/stern, outside shower, Deck brush, Deck lights, Electric anchor windlass, Fenders, Gangway, Grill (Barbecue) , Jerry can for fuel (outboard), Mooring Cleats, Mooring ropes , Round/globular fender, Spare anchor (Reserve, Auxiliary anchor), Spring cleats, Swimming ladder, Teak cockpit, Water hose, Winch handles, 110V socket, Air condition, Bilge pump - Electric, DSC station, Generator, Motor hours counter, Service batteries, Shore power cable, Start battery, VHF radio , Water heater, WC pump, Bilge pump - mechanic, Blankets, Clothes hangers, Electric fans in cabins, Electric toilet, Pillows, Toilet brush, Blender, Electrical filter coffee machine, Gas bottles, Gas cookers, Kitchen utensils (Galley equipment, cutlery), Microwave, Oven, Refrigerator, Toaster, Autopilot, Binoculars, Compass, GPS chart plotter, Nautical charts, Navigation set, Radar reflector, Tridata, Windex, Fins, Mask and snorkel, Radio CD mp3 player + USB, Stand up paddle (SUP)- FREE, Distress flare box, Emergency tiller, Fire extinguisher , First aid kit , Fog horn, Horseshoe lifebuoy, Life belts (Safety harness), Life jacket (children), Life jackets, Liferaft , Rescue sling (Life sling), Signal flags, Torch, Electric winch, Lazy bag, Winch

**KITCHEN:** Anchor with chain, Bimini top, Black Water Tank,

## PRICES AND AVAILABILITY

Lagoon 50 CU SAILING (2020)



<b>31.05. - 07.06.2025</b> 9.915 €	<b>10.06. - 18.06.2025</b> zarezerwowany	<b>19.06. - 26.06.2025</b> zarezerwowany	<b>28.06. - 05.07.2025</b> 9.445 €
<b>12.07. - 20.07.2025</b> zarezerwowany	<b>23.07. - 30.07.2025</b> zarezerwowany	<b>08.08. - 10.10.2025</b> zarezerwowany	<b>11.10. - 18.10.2025</b> 5.836 € <del>7.295 €</del>
<b>18.10. - 25.10.2025</b> 5.836 € <del>7.295 €</del>	<b>25.10. - 01.11.2025</b> 6.320 € <del>7.900 €</del>	<b>01.11. - 08.11.2025</b> 6.320 € <del>7.900 €</del>	<b>08.11. - 15.11.2025</b> 8.584 € <del>10.730 €</del>
<b>15.11. - 22.11.2025</b> 9.044 € <del>10.730 €</del>	<b>22.11. - 29.11.2025</b> 9.915 € <del>11.665 €</del>	<b>29.11. - 06.12.2025</b> 9.915 € <del>11.665 €</del>	<b>06.12. - 13.12.2025</b> 8.925 € <del>10.500 €</del>
<b>13.12. - 20.12.2025</b> 8.925 € <del>10.500 €</del>	<b>20.12. - 27.12.2025</b> Under option	<b>27.12. - 03.01.2026</b> Under option	